

Mor Electric Heating Assoc., Inc.

Salamander ALEX Radiant Fixture

Installation and Maintenance Instructions



Warning

THIS INSTRUCTION SHEET CONTAINS IMPORTANT INFORMATION FOR THE PROPER INSTALLATION, USE, AND EFFICIENT OPERATION OF THE ALEX RADIANT FIXTURE. CAREFULLY READ THIS SHEET BEFORE INSTALLING AND OPERATING THIS FIXTURE. FAILURE TO ADHERE TO THESE INSTRUCTIONS COULD RESULT IN FIRE, ELECTRICAL SHOCK, DEATH, SEVERE BURNS, OR PROPERTY DAMAGE.

Hazard of fire:

- For use in industrial process heating applications only. Not to be used in residential or commercial heating applications.
- Do not mount ALEX fixture near combustible materials or within a hazardous area.
- Do not recess the ALEX fixture into a wall. The fixture must be surface mounted using the included mounting brackets or hung by chain.
- Keep combustible materials away from fixture and emitter.
- Use high temperature wire for electrical connections within fixture/terminal area.

Electrical Shock:

- Disconnect electrical power before servicing emitters. All electrical wiring must be done in accordance to local electrical codes by a qualified service technician.
- Do not touch the ceramic emitters after power is applied to the emitters.
- For use in indoor protected environments only.
- Never immerse ceramic emitters in liquids.

Severe Burns:

- Ceramic emitters operate at high temperatures. Do not touch emitters or housing after power is applied.

High temperature wire, with insulation suitable for the load amperage and operating temperatures, must be used to make the power connections to the ceramic terminal blocks. **All electrical wiring must be done in accordance with local electrical codes by a qualified service technician.**

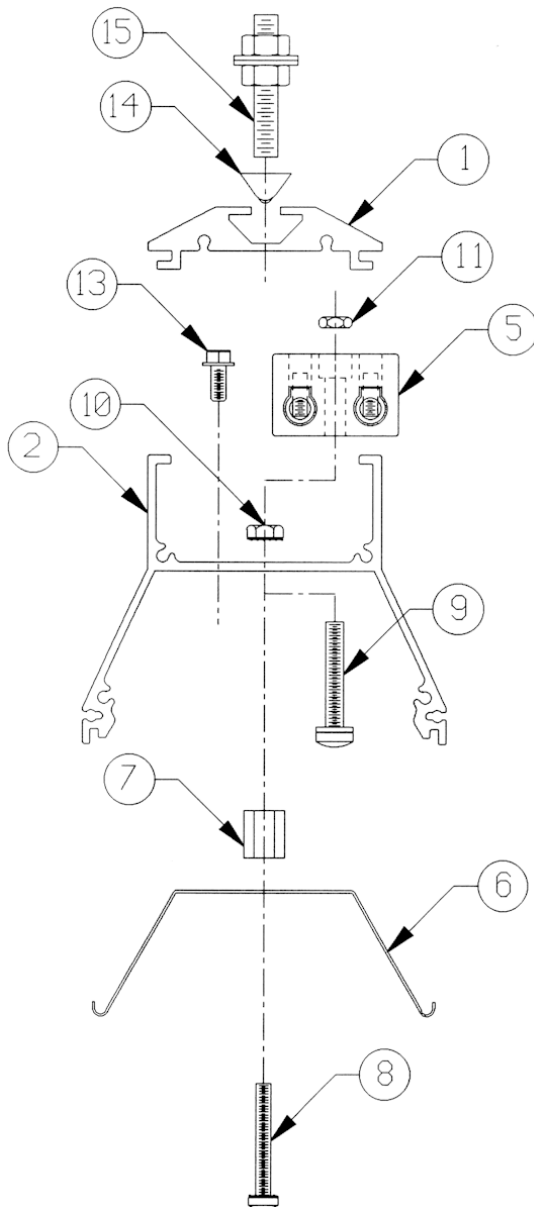

Reflector Assembly and Parts Identification

1. Alex: Terminal Cover Extrusion
2. Alex: H Section Extrusion
3. Alex: End Cap
4. Alex: Hole Plug For End Cap
5. TB-2 Ceramic Terminal Block
6. Alex: Ref-1 (Reflector)
7. Stand-Off
8. Screw: #8-32x1.25"
9. Screw: M4x30
10. Hex Nut: #8
11. Hex Nut: M4
12. Screw: #8x.25 Type-B
13. Green Ground Screw: #10-32x.375
14. 1/4-20 T-Slot Nut With Ball/Spring
15. 1/4-20x1.5 Stud, Hex Nuts & Washers

To order replacement parts contact Mor Electric Heating Assoc., Inc.

mor Electric Heating Assoc., Inc.

5880 Alpine Ave. NW, Comstock Park, MI, 49321, USA

Tel: 800-442-2581, 616-784-1121, Fax: 616-784-7775

www.InfraredHeaters.com sales@infraredheaters.com